

# Hydro Pneumatic Tool for Threaded Inserts

## 74200 Model

### Features

- Heavy duty plastic body and long-life components
- Lightweight and ergonomically designed
- Latest 'spin-pull' technology
- One-step trigger
- Can be suspended or hand-held

### Benefits

- Ideal for demanding production environments
- Quick and simple operation
- Reduces operator fatigue
- Increased productivity
- Places a wide range of threaded inserts
- Ensures accurate and secure thread installation

### Specifications

Weight	2.2 kg (4.9 lbs)
Pull Force	19.1 kN (4,300 lbf)
Stroke	7 mm (0.276 in)
Cycle Time	2.5 sec
Air Supply Pressure	5 – 7 bar
Free air volume	8 litres
Noise level	75 dB(A)
Vibration	<2.5m/s <sup>2</sup>

### Placing capability

Avdel threaded inserts up to M12.  
For detailed information on placing capability and nose equipment please refer to the tool manual on our website [www.avdel-global.com](http://www.avdel-global.com) or contact your local Avdel representative.

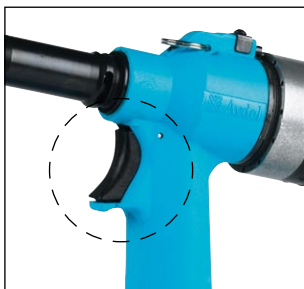

One-step trigger reduces cycle time to a minimum



### Dimensions (mm/inch)

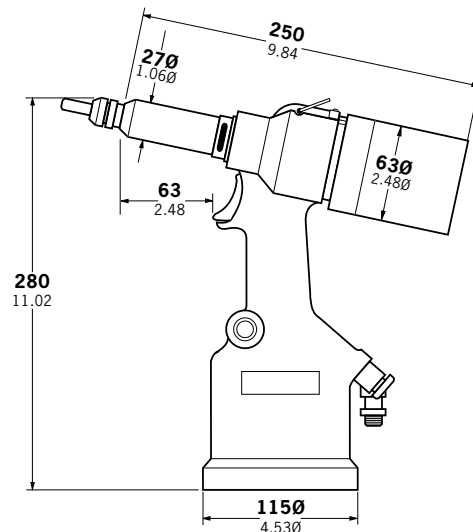

An Acument™ Global Technologies Company

[www.avdel-global.com](http://www.avdel-global.com)

Avdel UK Limited  
Pacific House, 2 Swiftfields  
Welwyn Garden City, Hertfordshire AL7 1LY  
Tel. +44 (0)1707 292-000 · Fax -199  
[enquiries@acument.com](mailto:enquiries@acument.com)

© 2007 Acument Intellectual Properties, LLC

04a.2007